

GS NEEDLE VALVE

3000 PSI SERIES
A105/F6
AISI316L/AISI316L

NEEDLE TYPE VALVE



MODEL CODE

SPECIFICATIONS

• Type	needle valve
• Body	block
• Material	A105/F6 - AISI 316L/AISI 316L
• Size	from DN6 up to DN50
• O-Rings	NBR, FPM, MQV, EPDM, FFKM
• Operating pressure	S3000: 210 bar S6000: 420 bar depending on valve size and seal materials selected
• Temp range	-20°C to +100°C for A105 -60°C to +230°C for AISI 316L

GS G^{1/2} DN13 S6000 316L/316L

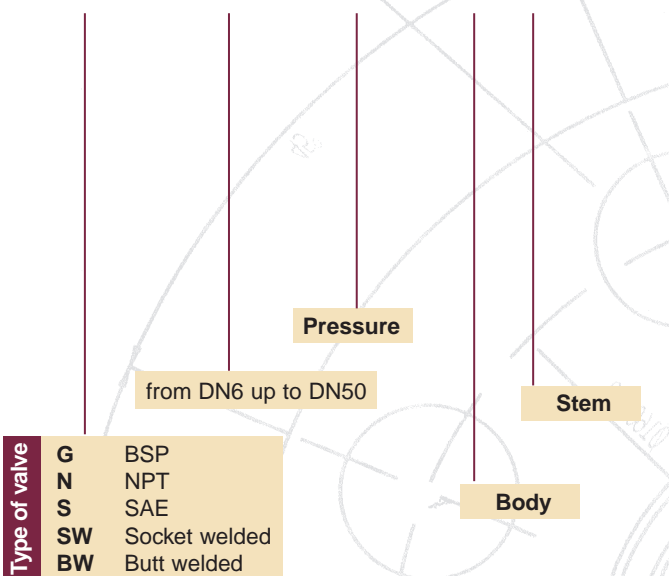

MATERIAL CLASSIFICATION

N.	DIN	W.Nr	AISI	ASTM
2	St 52-3	1.0570	-	A105
4	X2 CrNiMo 18 12	1.4435	316L	-
6	X5 CrNi 189	1.4301	304	-
L	14Ni6	1.5622		A350LF2

SEAL CLASSIFICATION

A	POM	G	PA 612
B	NBR70 (BUNA)	K	GEMPTFE
C	RPTFE	H	PCTFE
D	PEEK	I	KARLEZ®
E	FKM	L	MVQ (silicon)
F	EPDM	M	Metal to Metal

*For the complete list of plastic material compatibility see pp. 40.6

GS NEEDLE VALVE

3000 PSI SERIES

A105/F6

AISI316L/AISI316L

NEEDLE TYPE VALVE

TECHNICAL DRAWING

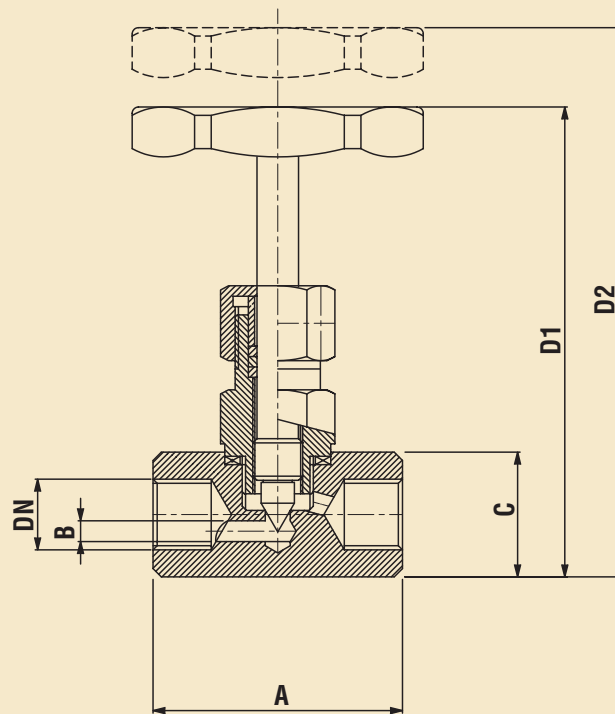

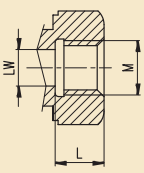

GS S3000 G DIN/ISO 228										A105/F6		S3000	
Type	DN	PN	A	B	C	D1	D2	Kg	Item Code				
 GS G 1/4	6	210	61	5	30	95	108	0.55	AS2GGT1F027F000				
GS G 3/8	10	210	61	6	30	95	108	0.55	AS2GGT2F027F000				
GS G 1/2	13	210	70	8	35	95	108	0.75	AS2GGT3F027F000				
GS G 3/4	20	210	78	9	40	100	112	1.10	AS2GGT4F027F000				
GS G 1"	25	210	90	11	50	128	135	2.00	AS2GGT5F027F000				
GS G 1" 1/4	32	210	100	15	60	155	170	2.50	AS2GGT6F027F000				
GS G 1" 1/2	40	210	130	19	70	165	180	3.00	AS2GGT7F027F000				
GS G 2"	50	210	140	22	80	174	190	3.50	AS2GGT8F027F000				

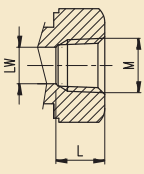
										S3000			
Type	DN	PN	A	B	C	D1	D2	Kg	Item Code				
 GS N 1/4	6	210	61	5	30	95	108	0.55	AS2NNT1F044F000				
GS N 3/8	10	210	61	6	30	95	108	0.55	AS2NNT2F044F000				
GS N 1/2	13	210	70	8	35	95	108	0.75	AS2NNT3F044F000				
GS N 3/4	20	210	78	9	40	100	112	1.10	AS2NNT4F044F000				
GS N 1"	25	210	90	11	50	128	135	2.00	AS2NNT5F044F000				
GS N 1" 1/4	32	210	100	15	60	155	170	2.50	AS2NNT6F044F000				
GS N 1" 1/2	40	210	130	19	70	165	180	3.00	AS2NNT7F044F000				
GS N 2"	50	210	140	22	80	174	190	3.50	AS2NNT8F044F000				

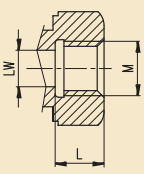
										S6000			
Type	DN	PN	A	B	C	D1	D2	Kg	Item Code				
 GS G 1/4	6	420	70	8	35	95	108	0.75	AS2GGT1G027F000				
GS G 3/8	10	420	70	8	35	95	108	0.75	AS2GGT2G027F000				
GS G 1/2	13	420	78	9	40	95	108	1.10	AS2GGT3G027F000				
GS G 3/4	20	420	90	11	50	100	112	2.00	AS2GGT4G027F000				
GS G 1"	25	420	100	15	60	128	135	2.50	AS2GGT5G027F000				
GS G 1" 1/4	32	420	130	19	70	155	170	3.00	AS2GGT6G027F000				
GS G 1" 1/2	40	420	140	22	80	165	180	3.50	AS2GGT7G027F000				

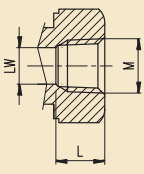
										S6000			
Type	DN	PN	A	B	C	D1	D2	Kg	Item Code				
 GS N 1/4	6	420	70	8	35	95	108	0.75	AS2NNT1G044F000				
GS N 3/8	10	420	70	8	35	95	108	0.75	AS2NNT2G044F000				
GS N 1/2	13	420	78	9	40	95	108	1.10	AS2NNT3G044F000				
GS N 3/4	20	420	90	11	50	100	112	2.00	AS2NNT4G044F000				
GS N 1"	25	420	100	15	60	128	135	2.50	AS2NNT5G044F000				
GS N 1" 1/4	32	420	130	19	70	155	170	3.00	AS2NNT6G044F000				
GS N 1" 1/2	40	420	140	22	80	165	180	3.50	AS2NNT7G044F000				

"The company reserves the right to operate dimensional changes without prior notice".

GS NEEDLE VALVE

3000 PSI SERIES

A105/F6

AISI316L/AISI316L

NEEDLE TYPE VALVE

EXPLODED DRAWING

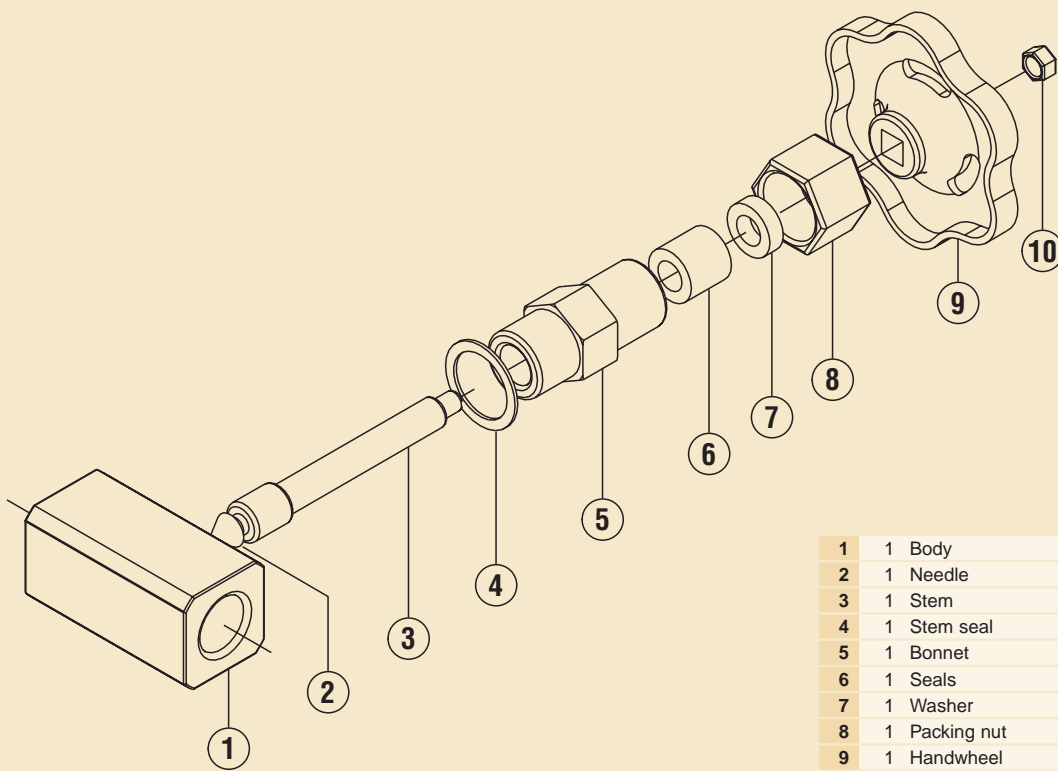

1	1	Body	A105 / AISI 316
2	1	Needle	F6 / AISI 316
3	1	Stem	F6 / AISI 316
4	1	Stem seal	RPTFE - GRAPHITE
5	1	Bonnet	A105 / AISI 316
6	1	Seals	RPTFE
7	1	Washer	Fe37
8	1	Packing nut	Fe37
9	1	Handwheel	Fe37
10	1	Nut	Fe37

MAXIMUM AND MINIMUM ADMISSIBLE WORKING TEMPERATURES FOR SEAL

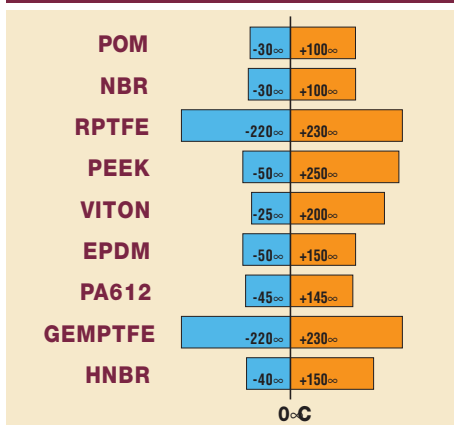

ON REQUEST

- Reduced bore
 - O-Ring in EPDM, FFKM, MQV
 - Seals in POM, PEEK, PA 612, RPTFE, GEMPTFE
 - Special Threads
 - Body in AISI 316L or A105
 - Needle in AISI 316 or F6
 - Pressure Class PN 100 to PN 500
- For further special requests please consult our technical/commercial service